



WAM range

air-blown water coolers



Cooler size	Cooling at 100°C ΔT KW	Coil press rating	Noise level dBA x 1 MTR	Pipe sizes (plain tube)	Nom water flow rate LPM	Fan power Kw #	AC Fan/Motor Amps			DC Fan/Motor Amps		Approx KG (dry)
							240 V 1 PH 50 HZ	400 V 3 PH 50 HZ	ENCL. IP	12 V	24 V	
WAE 1.8	2	15 Bar	45	3/8"	10	0.03	0.15	—	22	—	—	2.5
WADC 1.8	2	15 Bar	45	3/8"	10	0.01	—	—	—	0.52	0.25	2.5
WAE 3	3	15 Bar	45	3/8"	10	0.03	0.15	—	22	—	—	2.8
WADC 3	3	15 Bar	45	3/8"	10	0.01	—	—	—	0.52	0.25	2.8
WAE 7	7	15 Bar	53	3/8"	10	0.03	0.13	—	44	—	—	4.3
WADC 7	7	15 Bar	53	3/8"	10	0.02	—	—	—	1.40	0.70	4.3
WAE 11	11	10 Bar	68	3/8"	10	0.06	0.26	0.15	44	—	—	6.0
WAEQ 18	19	10 Bar	65	15mm	15	0.10	0.45	0.26	44	—	—	11.0
WAE 24	22	10 Bar	72	15mm	15	0.13	0.60	0.21	44	—	—	11.0
WAEQ 30	23	10 Bar	65	15mm	15	0.10	0.45	0.26	44	—	—	16.0
WAE 40	28	10 Bar	72	15mm	15	0.13	0.60	0.21	44	—	—	16.0
WAEQ 43	39	10 Bar	60	22mm	150	0.18	—	0.68	55	—	—	—
WAEQ 49	53	10 Bar	64	22mm	150	0.25	—	0.94	55	—	—	—
WAE 54	55	10 Bar	69	22mm	150	0.37	—	1.40	55	—	—	40
WAEQ 65	57	10 Bar	64	22mm	150	0.25	—	0.94	55	—	—	—
WAE 68	62	10 Bar	72	22mm	150	0.55	—	1.90	55	—	—	—
WAE 85	84	10 Bar	72	22mm	150	0.55	—	1.90	55	—	—	40

CAUTION - Noise Data

The noise values are given by the fan manufacturers in dBA and apply to 'free field' conditions. In practice different conditions lead to sound reflection, reverberation and resonance, dependent on insulation details. The resulting actual noise levels can be in excess of the nominal figure shown.

Please note: Fan/Motor powers and amps are for guidance only: Other Fan/Motor options may be fitted.

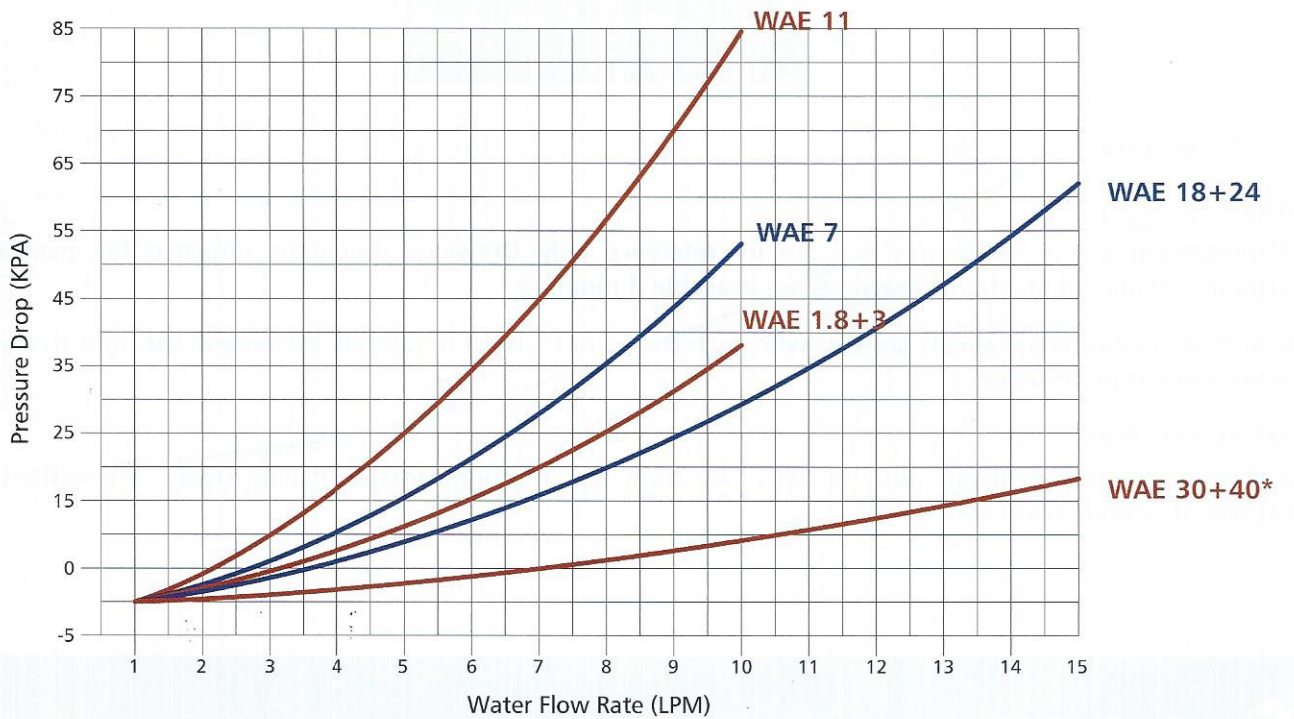
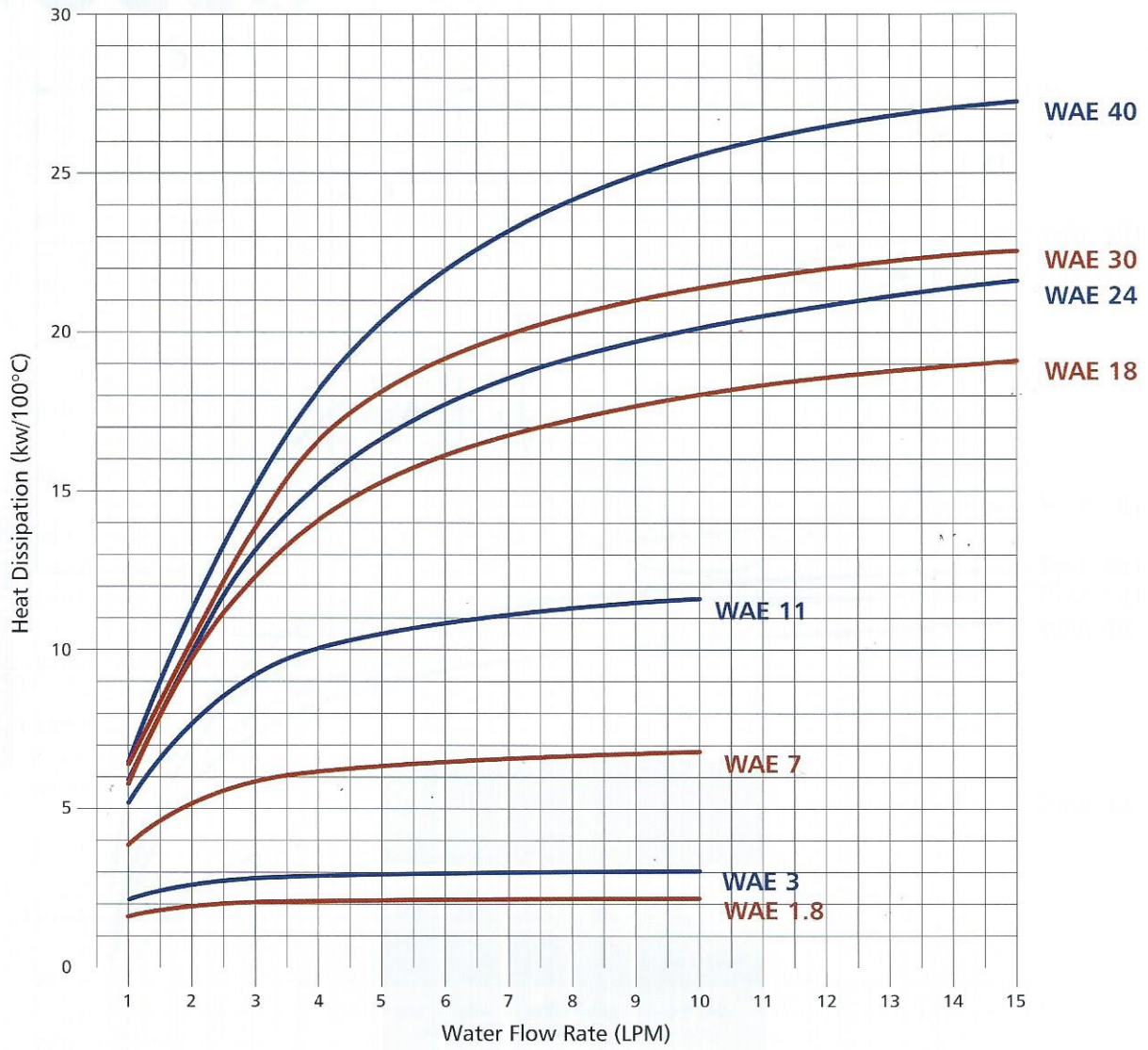

* 2010 00153 Pressure drop for WAE 30-40 is when the unit is piped in parallel

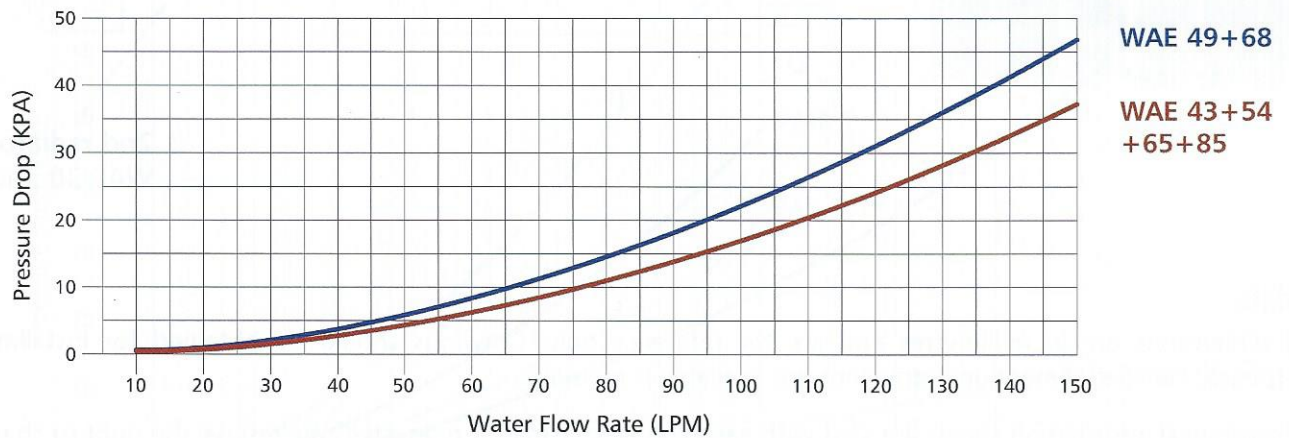
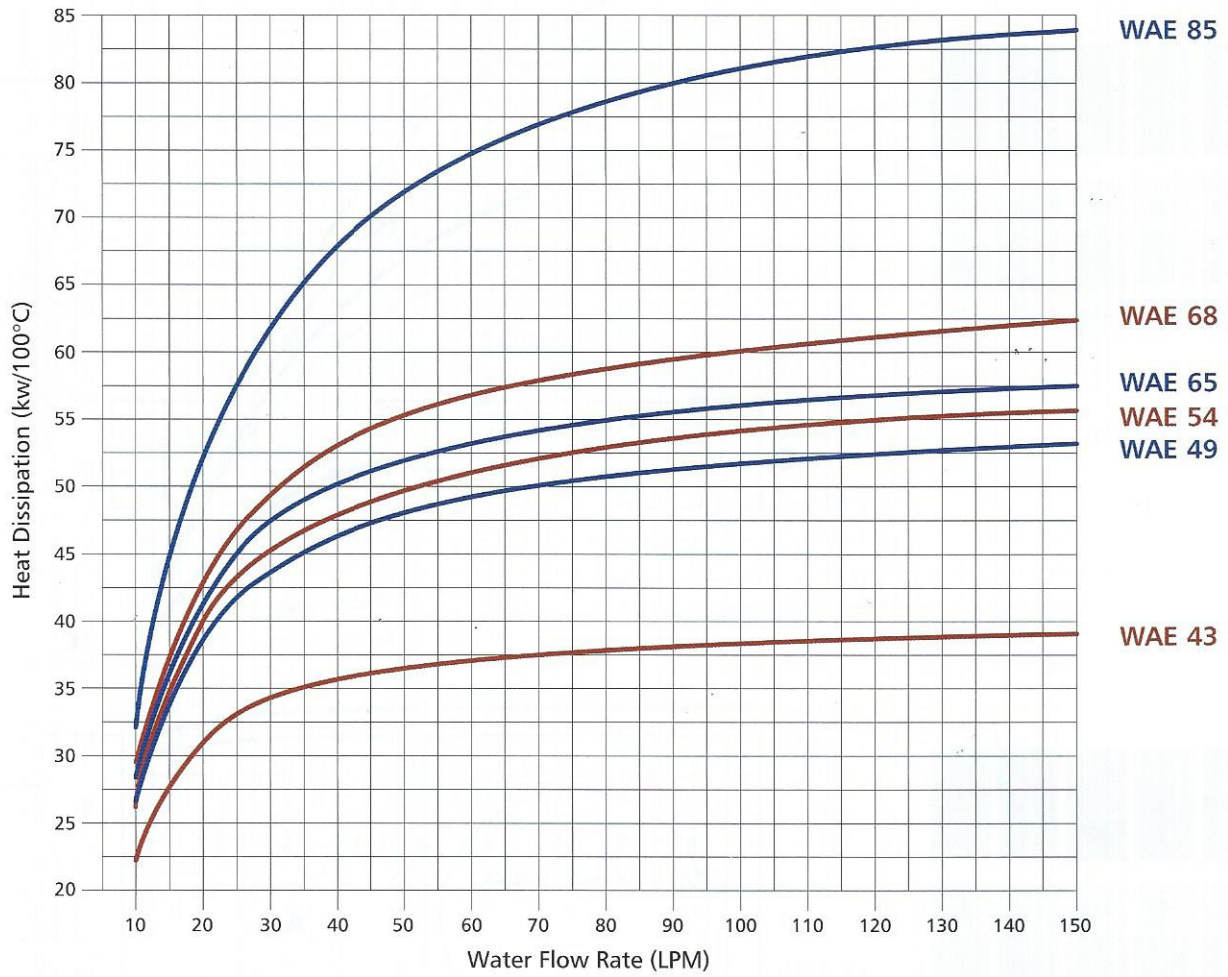

Cooler size	A	B	C	D
WAE (DC) 1.8	128	188	105	33
WAE (DC) 3	128	223	113	28
WAE (DC) 7	153	349	140	28

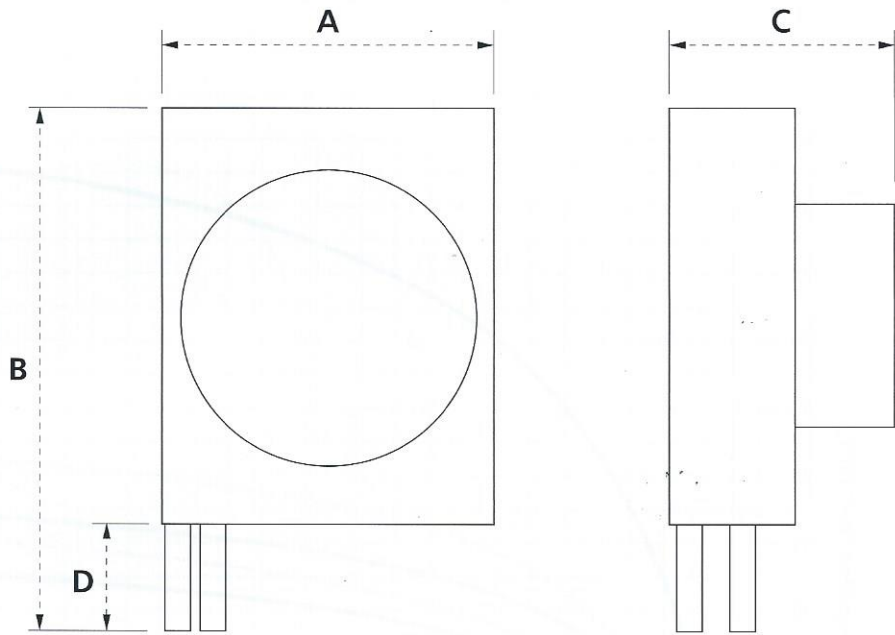

Cooler size	A	B	C	D
WAEQ 11	250	437	210	82
WAEQ 18	405	452	210	82
WAE 24	405	452	210	82
WAEQ 30	405	452	300	82
WAE 40	405	452	300	82

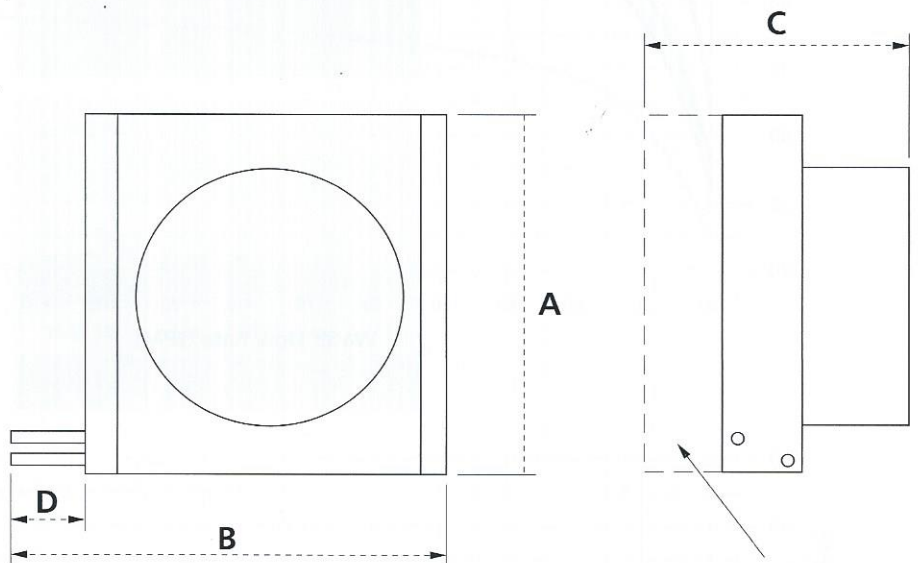

2nd radiator for WAE 30 and 40

Note:

All dimensions are in millimetres and are for reference only. Drawings should be obtained for installation purposes. Certified dimensional drawings are available if required.

Terotechnical information sheets are sent with each cooler, or earlier if requested. We reserve the right to change details without prior notice.

Notes on air flow

Air flow direction is generally pushing (type "A") from fan, through radiator. Pulling (type "B") versions are available. If critical please consult OCCO.

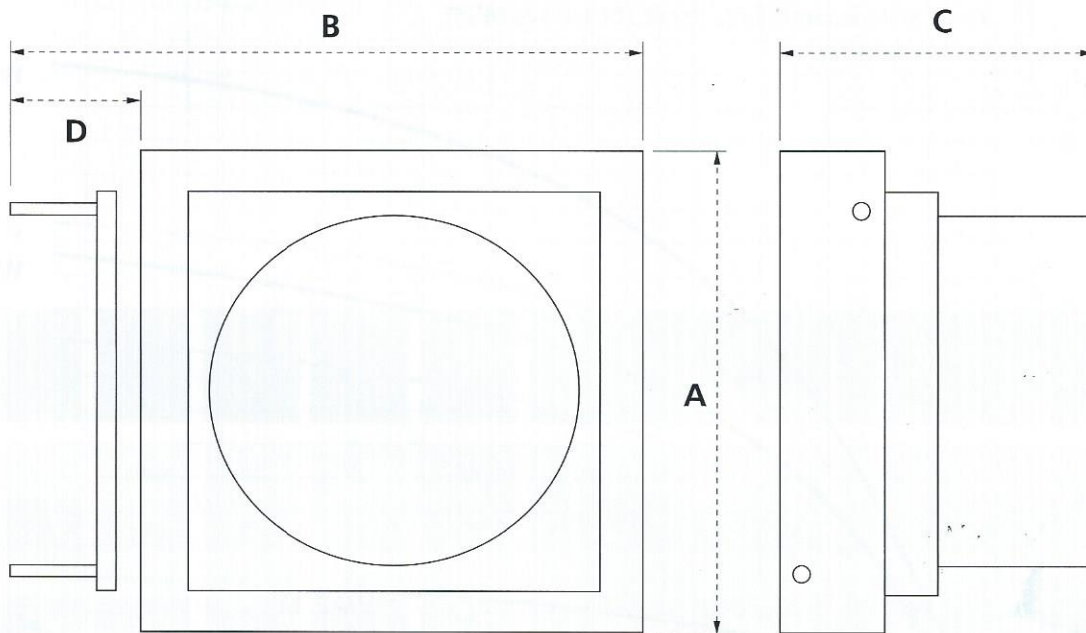

Cooler size	A	B	C	D
WAEQ 43	580	721	360	100
WAEQ 49	640	817	455	100
WAE 54	580	721	360	100
WAEQ 65	640	817	455	100
WAE 68	640	817	455	100
WAE 85	640	817	455	100

Note:

All dimensions are in millimetres and are for reference only. Drawings should be obtained for installation purposes. Certified dimensional drawings are available if required.

Terotechnical information sheets are sent with each cooler, or earlier if requested. We reserve the right to change details without prior notice.

Notes on air flow

Air flow direction is generally pushing (type "A") from fan, through radiator. Pulling (type "B") versions are available. If critical please consult OCCO.



www.occocoolers.co.uk

Occo Coolers Telford Ltd

Unit 19, St Georges Rd Ind Est
Telford TF2 7QZ

Tel: 01952 616381

Email: sales@occocoolers.co.uk